



circuit breaker 3VA1 IEC frame 100 breaking capacity class S Icu=36kA @ 415V 3-pole, line protection TM210, FTFM, In=63A overload protection Ir=63A fixed short-circuit protection li=10 x In nut keeper kit

| Model  |                             |
|--|-----------------------------|
| product brand name   | SENTRON                     |
| product designation  | Molded case circuit breaker |
| Product version  | Line protection             |
| design of the overcurrent release  | TM210                       |
| protection function of the overcurrent release   | LI                          |
| number of poles  | 3                           |
| General technical data   |                             |
| rated insulation voltage Ui  | 800 V                       |
| Max. rated operational voltage Ue with DC  | 500 V                       |
| power loss [W] / maximum   | 17.3 W                      |
| Active power loss / for rated value of the current / at AC / in hot operating state / per pole | 5.77 W                      |
| mechanical service life (switching cycles) / typical   | 20 000                      |
| Electrical endurance (switching cycles) / at AC-1 / at 380/415 V 50/60 Hz                      | 9 000                       |
| Electrical endurance (switching cycles) / at AC-1 / at 690 V 50/60 Hz                          | 6 300                       |
| Neutral conductors / upgradeable/retrofitable  | No                          |
| ground-fault monitoring version  | Without                     |
| product function   |                             |
| • communication function   | No                          |
| • other measurement function   | No                          |
| Net Weight   | 975 g                       |
| Current  |                             |
| Max. rated operational current of the frame size   | 100 A                       |
| Courant permanent assigné Iu   | 63 A                        |
| operational current  |                             |
| • at 40 °C   | 63 A                        |
| • at 45 °C   | 63 A                        |
| • at 50 °C   | 63 A                        |
| • at 55 °C   | 62 A                        |
| • at 60 °C   | 61 A                        |
| • at 65 °C   | 60 A                        |
| • at 70 °C   | 58 A                        |
| Switching capacity according to IEC 60947  |                             |
| switching capacity class of the circuit breaker  | S                           |
| breaking capacity maximum short-circuit current (Icu)  |                             |
| • at 240 V   | 55 kA                       |
| • at 415 V   | 36 kA                       |

|  |  |
|--|--|
| <ul style="list-style-type: none"> <li>• at 440 V</li> <li>• at 500 V</li> <li>• at 690 V</li> </ul>   | 25 kA<br>7 kA<br>7 kA  |
| breaking capacity operating short-circuit current (Ics) <ul style="list-style-type: none"> <li>• at 240 V</li> <li>• at 415 V</li> <li>• at 440 V</li> <li>• at 500 V</li> <li>• at 690 V</li> </ul>             | 55 kA<br>36 kA<br>25 kA<br>5 kA<br>5 kA  |
| short-circuit current making capacity (Icm) <ul style="list-style-type: none"> <li>• at 240 V</li> <li>• at 415 V</li> <li>• at 440 V</li> <li>• at 500 V</li> <li>• at 690 V</li> </ul>                         | 121 kA<br>75.6 kA<br>52.5 kA<br>11.9 kA<br>11.9 kA   |
| design of short-circuit protection   | For switching power values in DC networks, see the 3VA molded case circuit breaker device manual; link to be found under Service & Support in the last chapter |
| <b>Adjustable parameters</b>   |  |
| Adjustable response value current / li min.  | 630 A  |
| Adjustable response value current / li max.  | 630 A  |
| Ground fault protection / tripping switchable / I2t=ON/OFF   | No   |
| <b>Mechanical Design</b>   |  |
| height [in]  | 5.12 in  |
| Height   | 130 mm   |
| width [in]   | 3 in   |
| Width  | 76.2 mm  |
| depth [in]   | 2.76 in  |
| depth  | 70 mm  |
| <b>Connections</b>   |  |
| arrangement of electrical connectors / for main current circuit  | Front terminal   |
| type of electrical connection / for main current circuit   | nut keeper kit on both ends  |
| Type of connectable conductor cross-section, connection screw, width x thickness , min.  | 12 x 1 mm  |
| Type of connectable conductor cross-section, connection screw, width x thickness , max.  | 17 x 6.5 mm  |
| design of the surface / of the connections / on the top of the switch (N, 1, 3, 5)   | Silver   |
| design of the surface / of the connections / on the bottom of the switch (N, 2, 4, 6)  | Tin  |
| <b>Auxiliary circuit</b>   |  |
| number of CO contacts / for auxiliary contacts   | 0  |
| <b>Accessories</b>   |  |
| product extension / optional / motor drive   | No   |
| <b>Environmental conditions</b>  |  |
| protection class IP / on the front   | IP40   |
| ambient temperature <ul style="list-style-type: none"> <li>• during operation / minimum</li> <li>• during operation / maximum</li> <li>• during storage / minimum</li> <li>• during storage / maximum</li> </ul> | -25 °C<br>70 °C<br>-40 °C<br>80 °C   |
| <b>Certificates</b>  |  |
| reference code / acc. to IEC 81346-2   | Q  |
| <b>General Product Approval</b>  |  |
| EMC  |  |



[Miscellaneous](#)

[KC](#)



| Declaration of Conformity   | Test Certificates                            |  |  | Marine / Shipping   |
|---|--|--|--|---|
| <br>EG-Konf. | <a href="#">UK Declaration of Conformity</a> | <a href="#">Type Test Certificates/Test Report</a> | <a href="#">Special Test Certificate</a> | <a href="#">Miscellaneous</a><br><br>ABS |

| Marine / Shipping   | other  |  |   |  |                               |
|---|--|--|---|--|-------------------------------|
| <br>BUREAU VERITAS | <br>DNV | <br>LRS | <br>RMRS | <a href="#">CCS / China Classification Society</a> | <a href="#">Miscellaneous</a> |

**other**

[Miscellaneous](#)

**Further information**

**Information- and Downloadcenter (Catalogs, Brochures,...)**

<http://www.siemens.com/lowvoltage/catalogs>

**Industry Mall (Online ordering system)**

<https://mall.industry.siemens.com/mall/en/en/Catalog/product?mlfb=3VA1063-4ED32-0AA0>

**Service&Support (Manuals, Certificates, Characteristics, FAQs,...)**

<https://support.industry.siemens.com/cs/ww/en/ps/3VA1063-4ED32-0AA0>

**Image database (product images, 2D dimension drawings, 3D models, device circuit diagrams, ...)**

[http://www.automation.siemens.com/bilddb/cax\\_en.aspx?mlfb=3VA1063-4ED32-0AA0](http://www.automation.siemens.com/bilddb/cax_en.aspx?mlfb=3VA1063-4ED32-0AA0)

**CAX-Online-Generator**

<http://www.siemens.com/cax>

**Tender specifications**

<http://www.siemens.com/specifications>

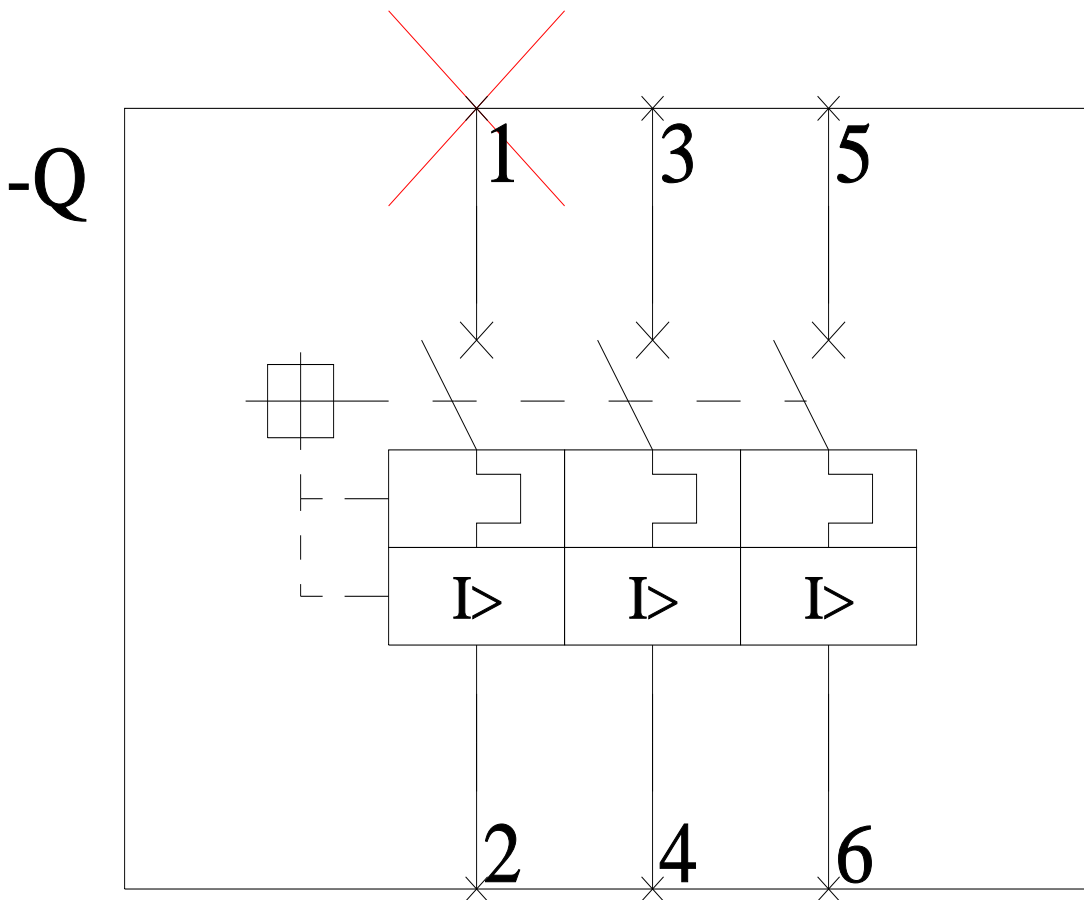
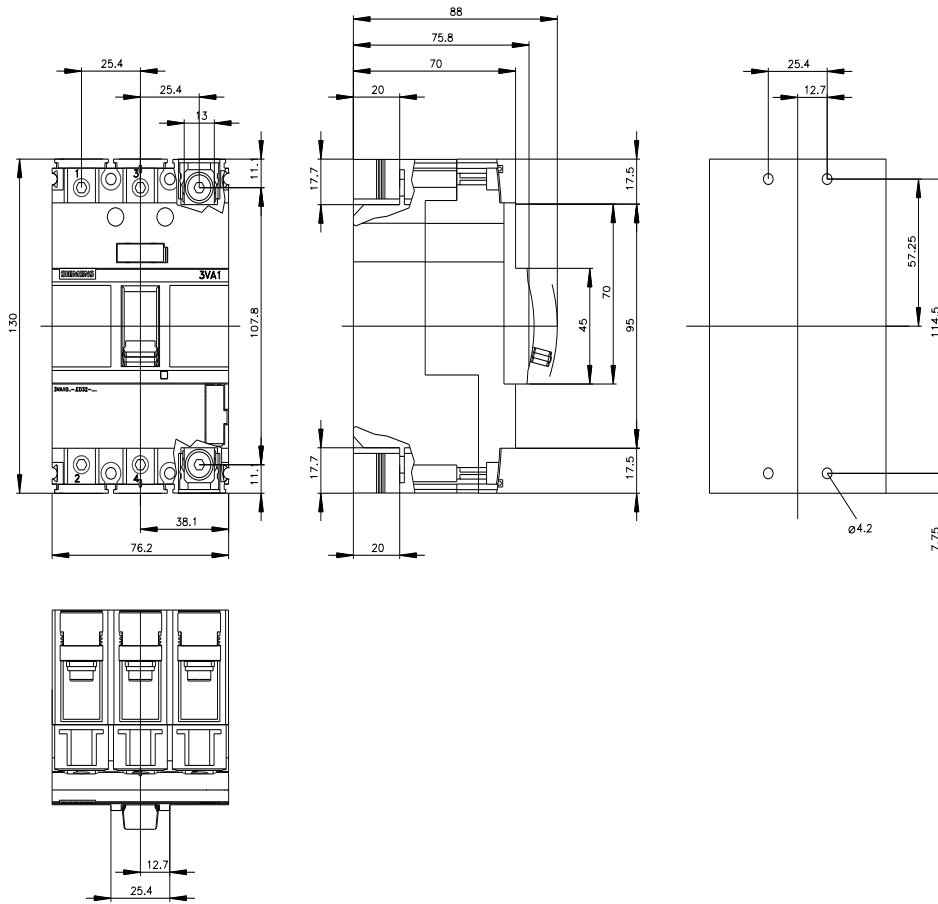

last modified:

10/3/2021



